

Floor Plan

- A scaled and measured diagram of the arrangement of a room, often including furniture placement.
- A birds eye view.



What is the room going to be used for?

How is the room going to be used?

Traffic Pattern

- Considering how the room will be used and walked through by the people, when designing a room.

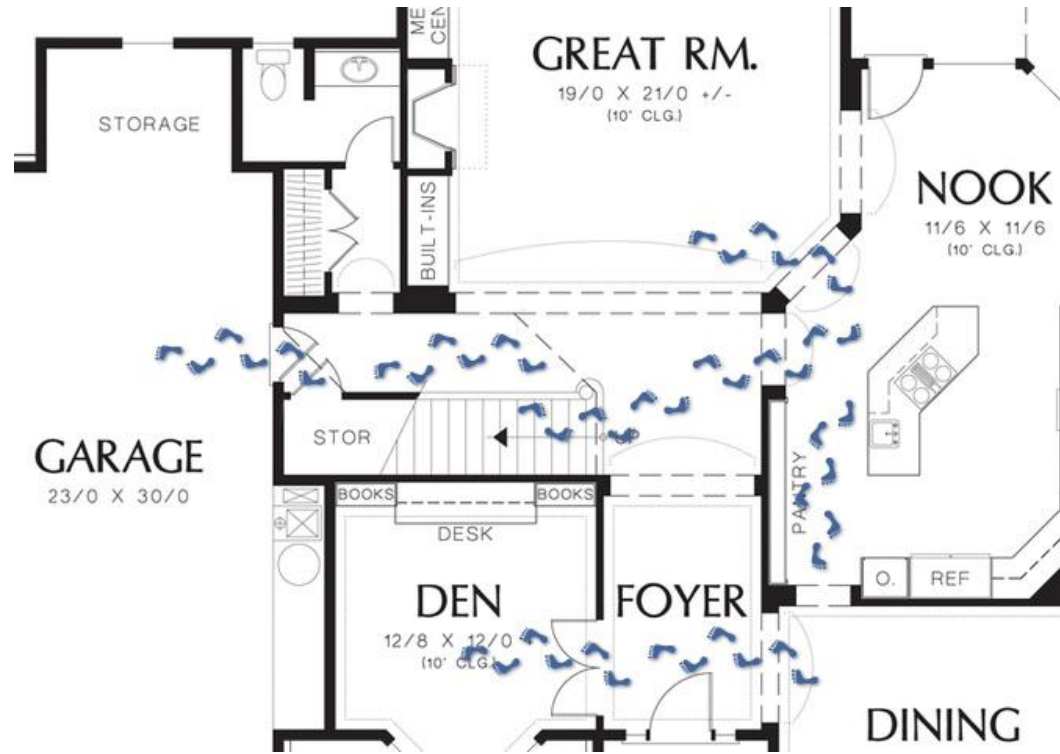

Are the people going to have enough space to get around comfortably?

Bad Examples:

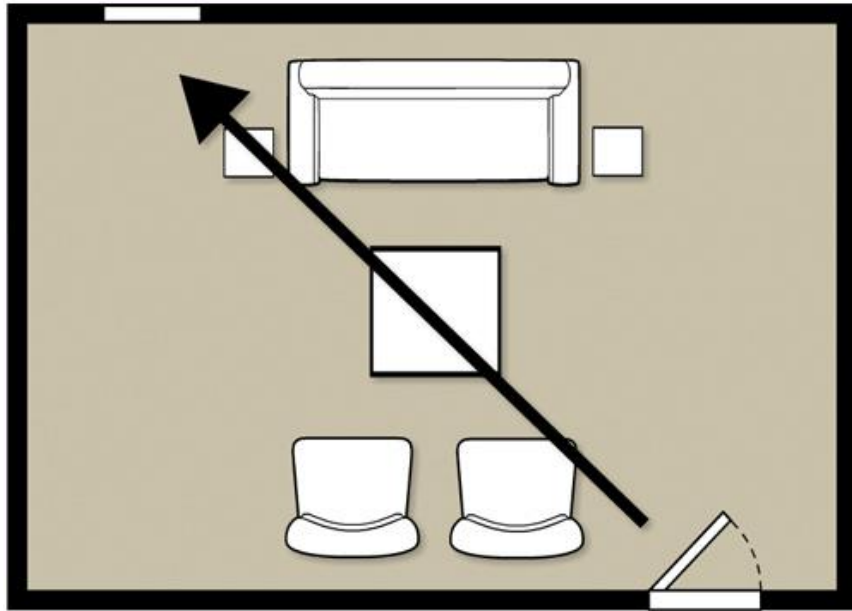

PLAN ONE: TROUBLESOME TRAFFIC PATHS

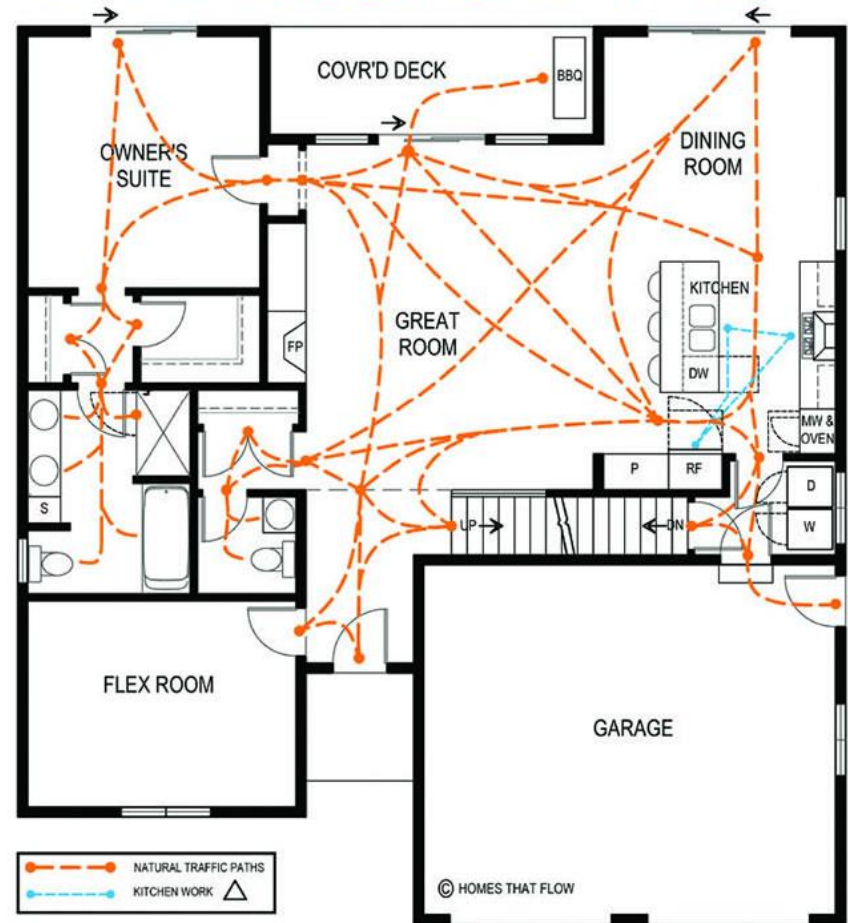

Today's Assignment:

- You are going to design your dream bedroom using an online **floor plan** system. As you design, please consider the **traffic pattern** of the room.
- When you are done, you will simply print and glue inside your packet.

Further Information:

- Visit www.homestyler.com
- Click “Join Now” and make an account
- Once you’re signed in, click on 3D floor planner.
- Create a room in the program. Make sure to consider traffic patterns. Print your final floor plan.
- Paste this floor plan inside your interior design housing note fold.